

MAX STAND INSTALLATION INSTRUCTION

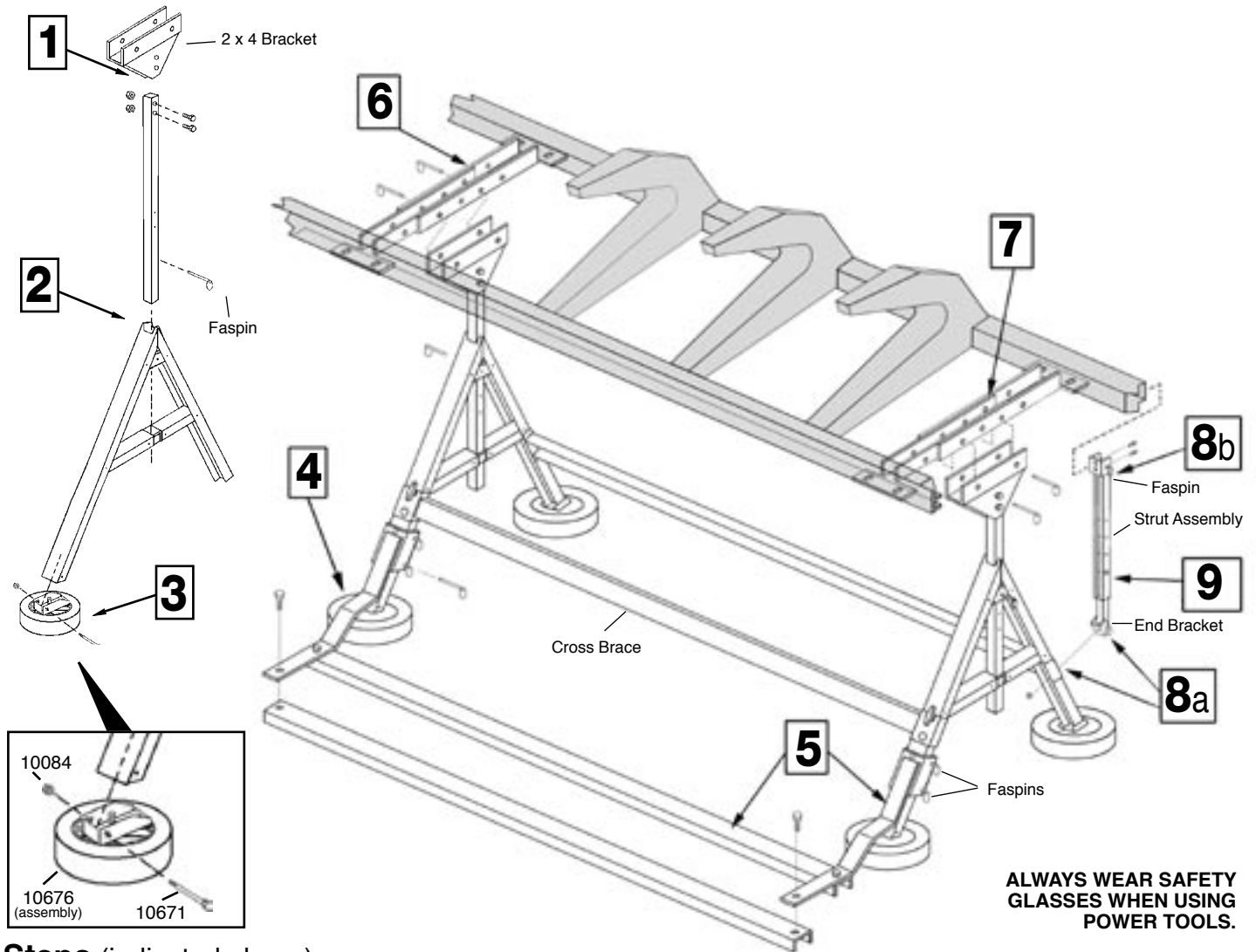

ALWAYS WEAR SAFETY GLASSES WHEN USING POWER TOOLS.

Steps (indicated above)

1. Remove all parts from box. Attach 2 x 4 Bracket to Vertical Support using 1/4-20 x 1 1/2" Hex Bolts and 1/4-20 2-Way Lock Nuts.
2. Slide Vertical Support into End Assemblies, securing with Faspin (part #10678).
3. Attach Wheel Assembly to End Assembly using 1/4-20 x 2 1/2" Hex Cap Bolt and 1/4-20 2-Way Lock Nut.
4. Fold wheels to pad position (as indicated in diagram) and stand End Assemblies apart. Attach Cross Braces to each Assembly (**see Detail A**). Align and tighten all 4 "T" Knobs snugly in place.
5. Install Stabilizer End Brackets. Insert all 4 Faspins into sides of End Bracket. Align Stabilizer Channels with End Brackets and install all 4 bolts through End Brackets and into each corner of Channels (10688 or 10689). (See Detail A also)
6. Assemble both Brake Brackets (**see Detail B** for correct hole positions) securing with hex nuts. Attach Brake Brackets to Bender with the (8) self-tapping screws provided (**see Detail C**).
7. Lift and lower Bender onto Max Stand by seating Brake Brackets into center of 2x4 Brackets. Align holes in Brackets and insert all Faspins.
8. Detach End Brackets from Strut Assembly and install to rear Outside Channels (**8a**) and Back Rail (**8b**) using 3/8-16 x 1" Hex Bolt (**8a**) and 1/4-20 x 3/4" Hex Wash HD Screw (**8b**). Re-attach to struts with faspins.
9. Adjust Strut Assembly by sliding Upper Strut over Lower Strut and install 1 1/2" bolt through proper Strut alignment hole and into both sections of Strut and tighten with hex nut.

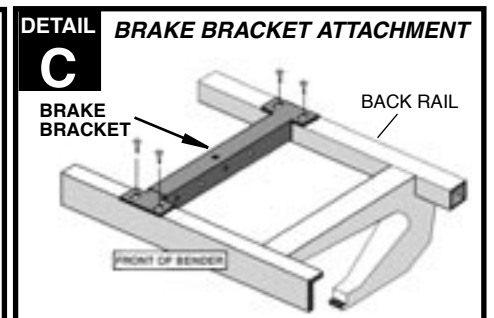
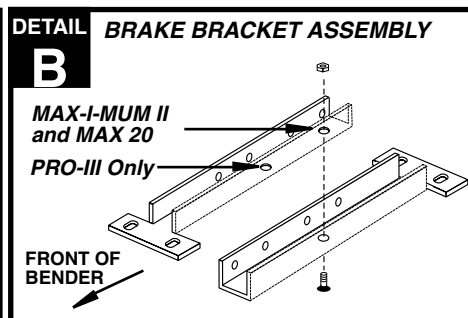
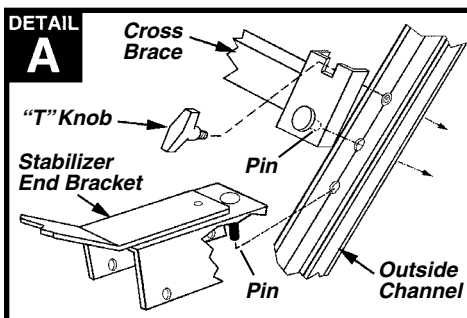

SETTING UP YOUR MAX-I-MUM II PORT-O-BENDER®

Hemming Handle Installation

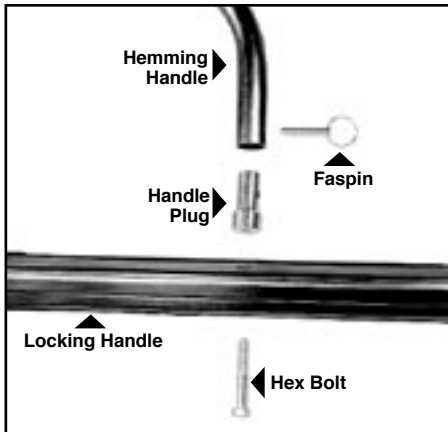

The MAX-I-MUM II Hemming Handle Assembly includes: (2) Hemming Handles, (4) Handle Plugs, (4) Faspins, (4) Hex Bolts.



Insert Hex Bolt through Locking Handle of your Port-O-Bender and into base of Hemming Handle as indicated using the 3/8" Hex Bolts provided. **HAND TIGHTEN ONLY.** Repeat for other side.



Attach the Hemming Handle over the Handle Plugs and secure them with Faspins. Now tighten the 3/8" Hex Bolts with a 9/16" wrench. Handle can be detached from now on by simply removing the Faspins.

Lifting/Bending Handle Installation

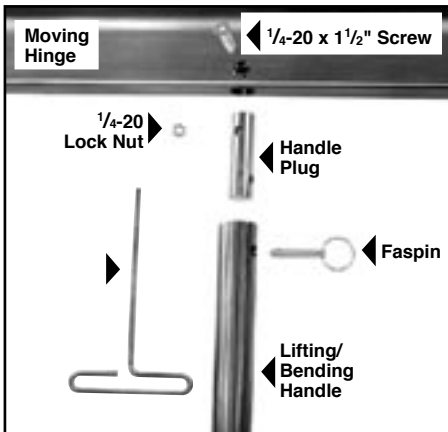

Exploded view of Handle Assembly — First insert one end of Handle Plug into Lifting/Bending Handle and install Faspin through holes.

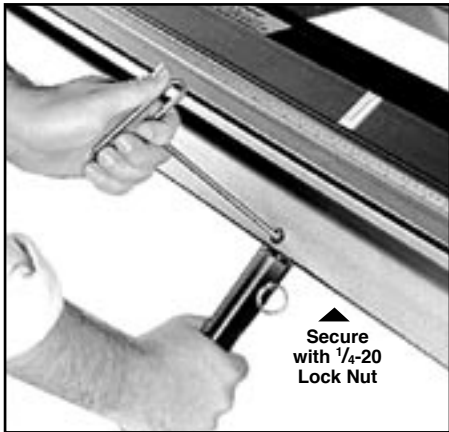

Next, insert Handle Assembly into hole in bottom of Moving Hinge. Align hole in hinge with Handle Plug and insert screw using Allen wrench as shown. Secure with 1/4-20 Lock Nut.



Repeat for other handles. To remove handles now, simply release Faspins. Always use more than one handle when bending.

Hinge Clip Installation

The Hinge Clip keeps the Moving Hinge in position for ease of aligning material. It can also prevent rippling of the material during cut off operations.

To install Hinge Clip, locate predrilled hole on bottom center of Moving Hinge. Align holes in Clip and Hinge as shown and insert Phillips head screw provided.

Note: You must engage Hinge Clip for proper operation of Max Cut-Off.

