

## Setting up the MX Series™ Brake

### Locking bar Installation

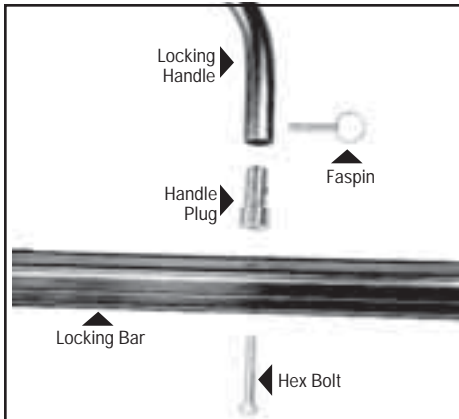

MX Locking Bar Assembly includes:  
 (2) Locking bars,  
 (4) Handle Plugs, (4) Faspins, (4) Hex Bolts

1. Insert Hex Bolt through Locking bar of your MX Series™ Brake and into the base of Locking bar(s) as indicated using the 3/8" Hex Bolts provided. **HAND TIGHTEN ONLY.** Repeat for other side.
2. Attach the Locking bar over the Handle Plugs and secure them with Faspins. Now tighten the 3/8" Hex Bolts with a 9/16" wrench. Handle can be detached from now on by simply removing the Faspins.

### Lifting/Bending Handle Installation

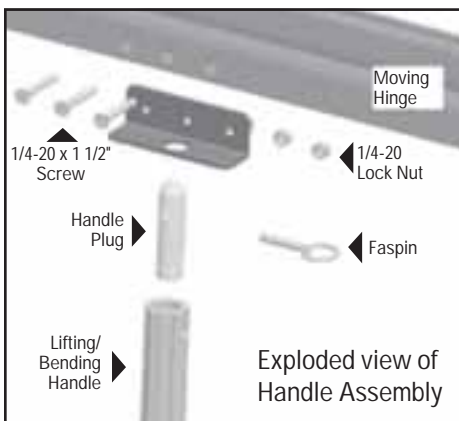

1. First insert one end of the Handle Plug into Lifting / Bending Handle and install Faspin through holes.
2. Next, insert Handle Assembly into hole in bottom of Moving Hinge. Align hole in hinge with Handle Plug and insert screw using Phillips Screw Driver as shown. Secure with 1/4-20 Lock Nut

Repeat for other handles. To remove handles, simply remove Faspins. Always use more than one handle when bending.

# MX Stand™ Set-up

Hardware Requirements: (2) 7/16" & (2) 9/16" Open end wrench.

## STEP 1

Attach Stand Counter Balance Brackets to Plank with Carriage Bolts and Nylock Nuts using a 7/16" Socket or Open end Wrench.

Counter Balance is required for operation.

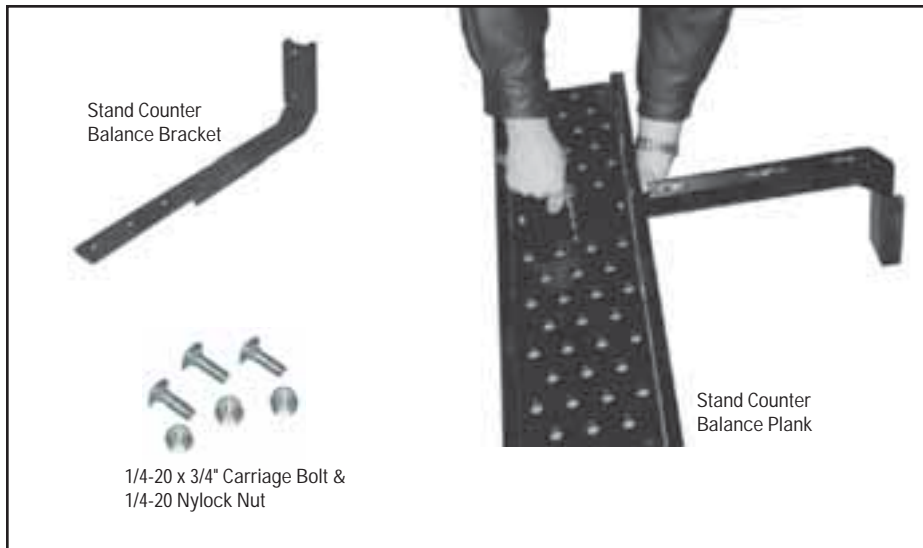

## STEP 2

Slide Stand Counter Balance Assembly up to the Stand Legs. Insert the 3/8-16 x 2 3/4" Hex Bolts through the Stand Counter Balance Bracket and Leg as shown in Figure 2. Use a 9/16" wrench to tighten down 3/8-16 Nylock Nut.

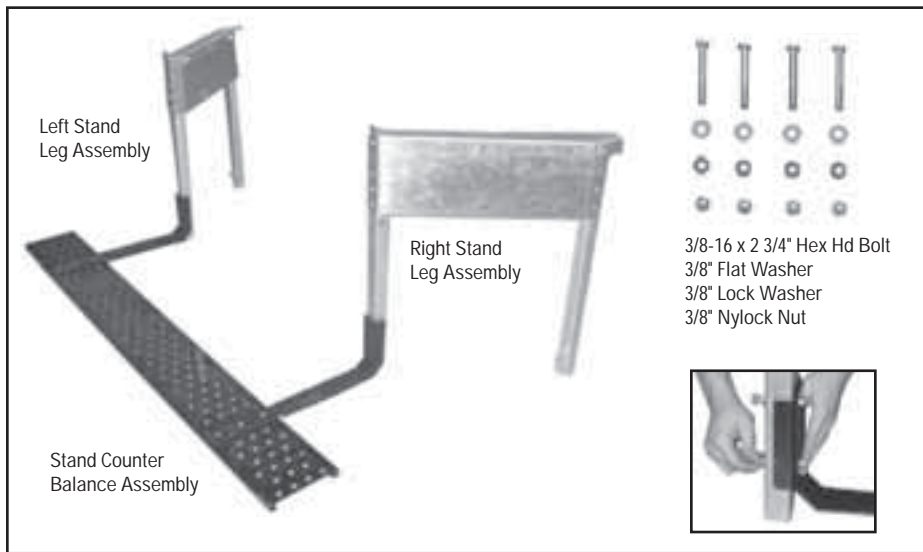

## STEP 3

Insert Front Support Tube through both Right and Left Legs as shown in Figure 3. Next slide the 1/4-20 x 2 1/2" bolt through the Stand Leg and Support tube. Use the 7/16" wrench to secure the Support Tube in place with 1/4-20 Nylock Nuts.



# MX Stand™ Set-up

## STEP 4

Rotate the Toggle Pin 90 degrees and slide the Rear Cross Tube onto the Pin. To secure the Tube in place allow the arm on the Toggle Pin to drop down. Repeat steps in all locations.

Rotate arm on Toggle Pin to insert Rear Support Tube.

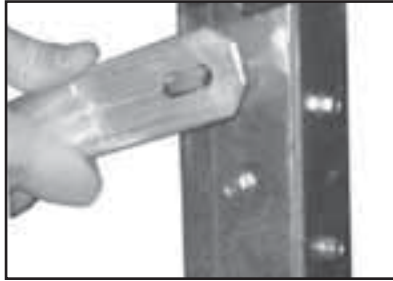

Toggle Pin in Locked position.

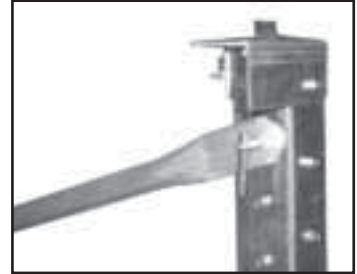

Toggle Pin (locked)



Toggle Pin (unlocked)



Rear Cross Tube Assembly

## Installing a MX Series™ Brake on MX Stand™

### STEP 5

Align the hole in the Fixed Hinge with the Slot on the Stand Top Bracket. See 5a.

Insert Faspin through the Stand Top Bracket and into the Fixed Hinge to secure Brake in place. See 5b.

The Brake must be secured with Faspins on the Left & Right Stand Leg Assemblies.

Using 2 people, set Brake on Stand with the hinges above the Front Support Tube.

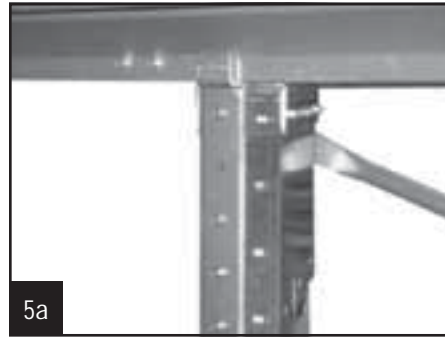

### STEP 6

Place Back Rail Clamp on the Back Rail. Slide Knob through the Wedge and turn clockwise into the Threaded Insert. See 6.

Back Rail Clamp Assembly must be attached on Left and Right Stand Leg Assemblies.

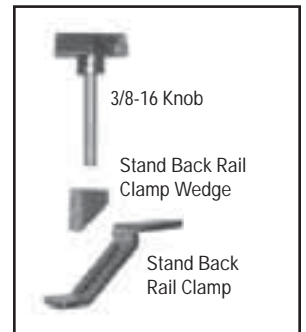
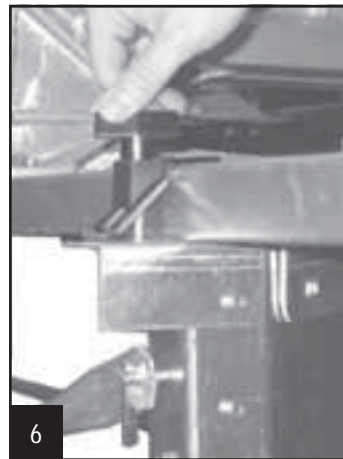

## Removing a MX Series™ Brake from MX Stand™

- Removing the brake from the MX Stand is essentially the opposite of attaching it to the stand.
- Remove the Back Rail Clamp Assembly from the Stand.
- Lift the Moving Hinge and remove the Faspins and place in the Stand Leg Faspin storage hole.

## Setup for Adjustable MAX Cut-Off

### LIST OF PARTS:

- (1) Adjustable MAX Cut-Off
- (2) MX Material Stop Kit #14485

### Tools Needed for Initial Set Up:

- hammer, punch or nail set,
- 9/16" wrench, Phillips screw driver.

### IMPORTANT! Read this safety information before using product.

1. Always keep hands and fingers clear of the knives during all phases of use.
2. If using both hands to push tool through material, ensure hands are not in the path of the exiting material as it leaves the rear area of the tool.
3. Remove cut-off from anvil prior to bending material. Failure to do so can cause the tool to fall from brake resulting in tool damage or personal injury to user.
4. Never use tool to cut material not firmly clamped in brake.



1. Slide measuring tapes into Pivot Arm slots from rear of Pivot Arm till they stop. Tape measures take into account 1 1/2" difference between the bending edge and the shear point of Cut-Off for accurate cuts.



2. Slide material stop onto Pivot Arms from rear as shown. Note: Recommended locations are on the second castings in from each end of your brake.



3. Secure the tape measures in place by "punching" down the edge of the pivot arm onto the tape measure. Use a standard nail set or punch.