

UNIVERSAL WORK STAND

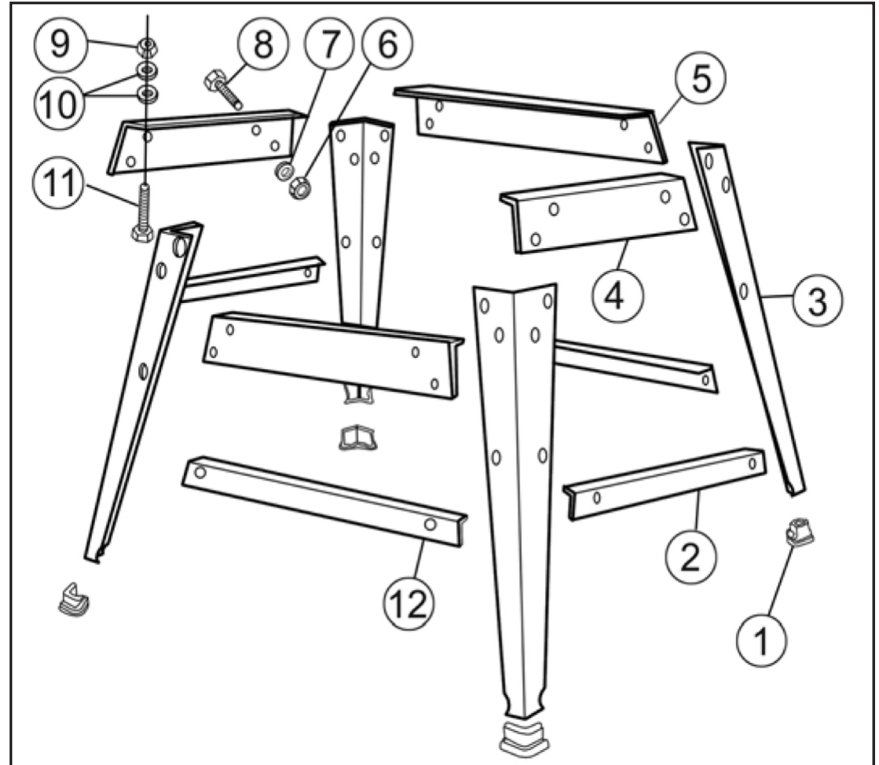

Tools Required for Assembly

10mm or Adjustable Wrench

ITEM NO.	DESCRIPTION	QTY	ITEM NO.	DESCRIPTION	QTY
1	Rubber Foot	4	7	Washer 8mm	24
2	Side Beam	2	8	Hex Head Screw M6 x 12	24
3	Legs	4	9	Hex Nut M6	8
4	Side Panel	2	10	Washer 6mm	8
5	Front Panel	2	11	Hex Head Screw M6 x 40	4
6	Hex Nut M6	24	12	Front Beam	2

To Assemble:

Install one side beam (part #2) and one side panel (part #4) to a pair of legs (part #3) as shown. Make sure that the side beam and the side panel are positioned on the inside of the legs.

Add the rubber feet (part #1) to the bottom of the legs.

Repeat this process for the second leg assembly. Now that both assemblies are complete, join them together with two front panels (part #5) and two front beams (part #12).