



New Tech Machinery

The World's Finest Portable Rollforming Equipment



# MACH II™

## Gutter Machines

### 5", 6", 5-6 Combo

[www.NewTechMachinery.com](http://www.NewTechMachinery.com)

# MACH II™ Gutter Machines

The "ORIGINAL" polyurethane drive system. VERSATILE...INNOVATIVE...DEPENDABLE...PROFITABLE

New Tech Machinery's patented MACH II gutter machines have changed the gutter industry forever.

Don't get stuck with an imitation, DEMAND THE ORIGINAL!

STANDARD FEATURES (with loaded machines)	
• Polyurethane Drive rollers	• Two 360° Rotatable Reel Stands with Easy Lift Reels
• Stainless Steel Forming Rollers	• Electric Motor 3/4Hp, 110VAC, 60Hz, 1Ph, 11 AMPS
• Push Button RUN/JOG controls at Entry and Exit Ends	• Welded Tubular Steel Frame
• Forward Pulling, Easy Cut Shear	• Industry's Best Warranty
• Power Interruption Safety Circuit	

OPTIONS	
<b>ROS1; ROS3</b> – Run Out Stand ; Set of 3 Run Out Stands	<b>ELEC2</b> – 3/4 Hp, 110VAC, 50 Hz, 1Ph, 11Amps
<b>RL15</b> – 15" Reel (380mm)	<b>ELEC3</b> – 3/4 Hp, 220VAC, 50Hz, 1Ph, 5Amps
<b>RL20</b> – 20" Reel (500mm)	<b>12 VOLT</b> – 1Hp, 12VDC, 80Amps (Battery not included)
<b>TRN</b> – Turnstile Reel Stand	<b>BB5</b> – Bottom Bead Assembly, 5"
<b>RAC</b> – Transfer Bars	<b>BB6</b> – Bottom Bead Assembly, 6"
<b>CR 5/6</b> – 5" Cradle and/or 6" Cradle	<b>BF5</b> – 1" Back Flange for 5"
<b>REM-2</b> – 2-Button Remote Control	<b>BF5SH</b> – 1" Back Flange Shear for 5"
<b>GFI</b> – Ground Fault Interruption Plug	<b>BF15-5</b> – 1-1/2" Back Flange for 5"
<b>HK5/ HK6</b> – Alcoa Hook Assembly, 5" or 6"	<b>BF15-5SH</b> – 1-1/2" Back Flange Shear for 5"
<b>HK56</b> – Alcoa Hook Assembly, 5"/6" Combo	<b>BF6</b> – 1" Back Flange for 6"
<b>RISER 6-8; RISER 10-12</b> – Riser Pad 6"-8"; Riser Pad 10"-12"	<b>BF6SH</b> – 1" Back Flange Shear for 6"
<b>CVR-GM5/6/56</b> – Machine Covers	<b>BF15-6</b> – 1-1/2" Back Flange for 6"
<b>EZC-G</b> – EZ-Counter Computerized Length Controller	<b>BF15-6SH</b> – 1-1/2" Back Flange Shear for 6"

SPECIFICATIONS	
<b>5" Gutter Machine</b> <ul style="list-style-type: none"> <li>Length 8' (2.4m)</li> <li>Width 2' (.6m) plus shear handle</li> <li>Height 3'10" (1.2m)</li> <li>Weight 1000 lbs (454kg)</li> </ul>	<b>MATERIALS FORMED</b> <ul style="list-style-type: none"> <li>Painted Steel 30 ga. to 24 ga. (.3mm to .6mm)</li> <li>Painted Aluminum .019" to .032" (.5mm to .8mm)</li> <li>Copper 16 oz. to 20 oz. 3/4 Hard (.5mm to .7mm)</li> </ul>
<b>6" Gutter Machine</b> <ul style="list-style-type: none"> <li>Length 10' (3.0m)</li> <li>Width 2' (.6m) plus shear handle</li> <li>Height 3'10" (1.2m)</li> <li>Weight 1250 lbs (570kg)</li> </ul>	<b>SHEAR</b> Manually Powered, Hardened Tool Steel Blade and Dies
<b>5" - 6" Combo Gutter Machine</b> <ul style="list-style-type: none"> <li>Length 10' (3.0m)</li> <li>Width 2' (.6m) plus shear handle</li> <li>Height 3'10" (1.2m)</li> <li>Weight 1350 lbs (610kg)</li> </ul>	<b>MATERIAL WIDTH</b> <ul style="list-style-type: none"> <li>5" Machine: 11-3/4" to 12-3/8" (300mm to 315mm)</li> <li>6" Machine: 15" (380mm)</li> </ul>
<b>SPEED</b> <ul style="list-style-type: none"> <li>50 ft./min (15m/min) Approx.</li> </ul>	<b>DRIVE</b> <ul style="list-style-type: none"> <li>Electrically Driven Polyurethane Rollers</li> </ul>

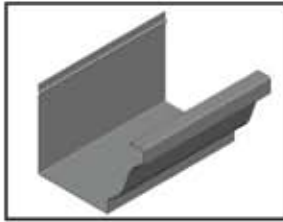

Straight Back Gutter

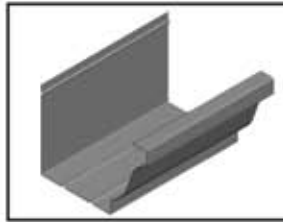

Gutter w/ Bottom Bead

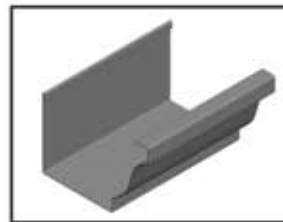

Gutter w/ Alcoa Hook

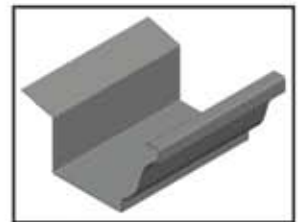

Gutter w/ Back Flange

## Options



Shear



Coil Cradle



2 Button Remote Control (start, stop)



Push Button Controls



Turnstile Reel Stand



EZ-Counter Computerized Length Controller

## Warranty

- Three years parts / Three years labor (including electrical)
- Limited lifetime against separation on drive rollers
- Limited lifetime on stainless steel forming rollers

U.S. PATENT NO. 5,394,722  
U.S. PATENT NO. 5,740,687