

Tail Light Brackets for Adjustable Angle Side Roller Guide On's

Installation Instructions

Part #86107

This kit contains the following components:

| # | Qty. | Part # | Description |
|---|------|--------|----------------------|
| 1 | 2 | 44701 | Light Brackets |
| 2 | 4 | 10027 | Nyloc Nut 1/4"x 3/4" |
| 3 | 4 | 10518 | Bolt 1/4"x 3/4" |
| 4 | 2 | 17417 | Rubber Grommet |

Tools required:

1/4" wrench, 1/4" Drill & a pencil or marker

Installing your Tail Light Bracket:

- Determine position for light bracket:
 - A - Roller Side Guide (Skip to #6)
 - B - Side of the Trailer Frame
- With the bracket in position use a pencil or magic marker and place marks on the trailer tube thru the bracket mounting holes.
- Remove the light bracket.
- Drill two 1/4" holes in the trailer frame, using the marked position as a guide.
- Clean and debur the drilled holes.
- Attach the bracket in place with (2) 1/4" bolts and 1/4" nyloc nuts. Do not tighten.
- Check the bracket location for any interference.
- Tighten bolts and nuts with a 1/4 wrench.
- Repeat 2-8 for the other side light bracket.
- Place the rubber grommets in the large hole in the center of the bracket. This can be used for wiring access.
- Install light kits according the manufacturer's installation instructions.

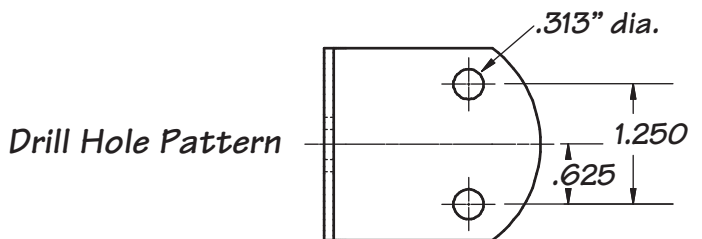
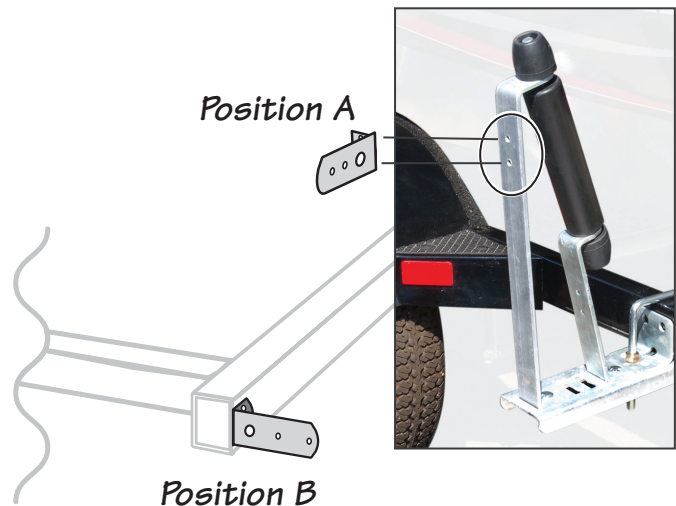
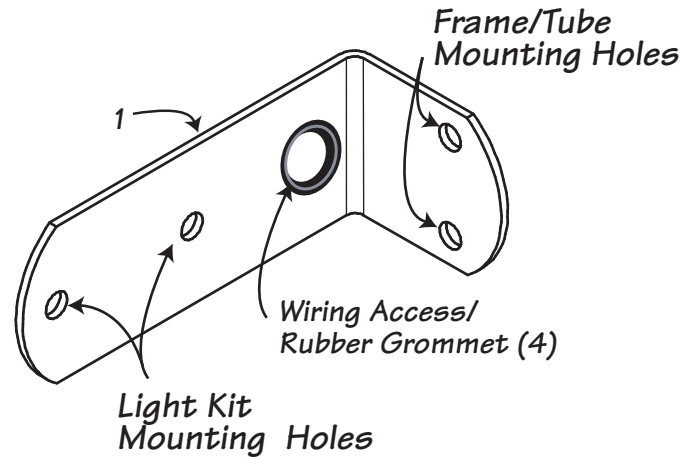

Instructions #15313 (A1109 - Rev. 7/17/19)